

## ● Hide board edges、 Prevent cracks

H type

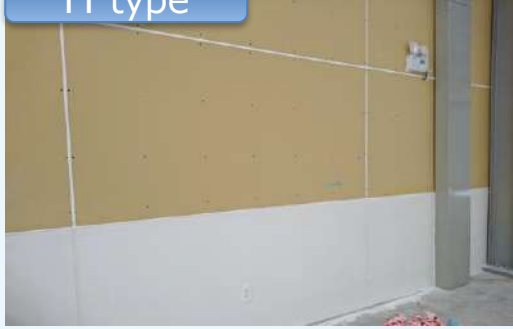

H125V

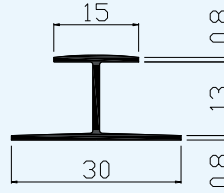

H95V

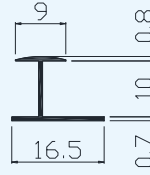

J type

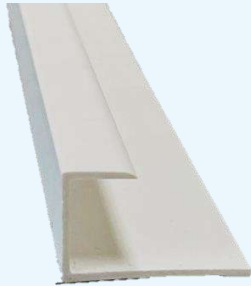
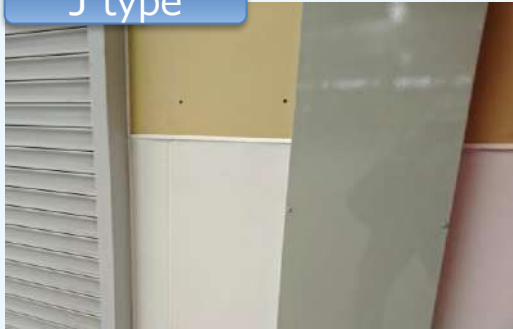

J125V

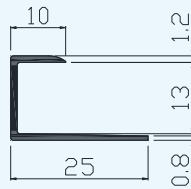

J95V



HAT type

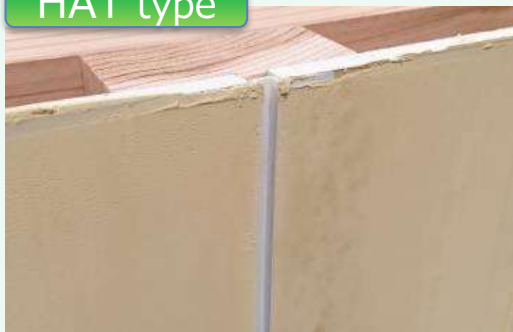

HAT V5

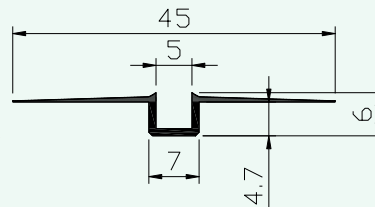

## Key features

H type

J type

- Easy joint treatment
- Easy to hide edges
- Suppresses scattering of gypsum powder
- Clean finish

HAT type

- Prevents cracks
- For paint finish
- Projection prevents putty from entering joints

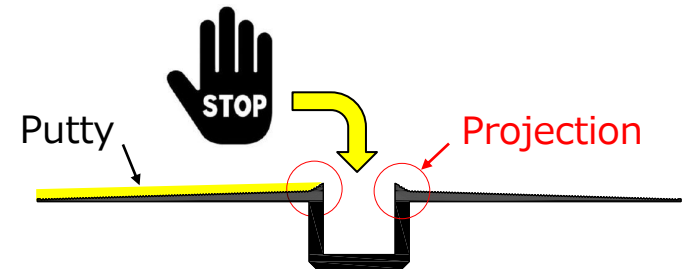

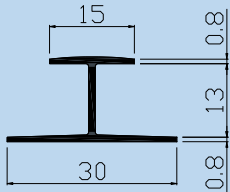
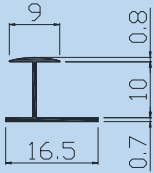
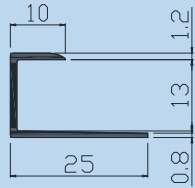
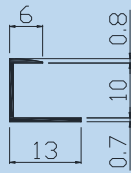
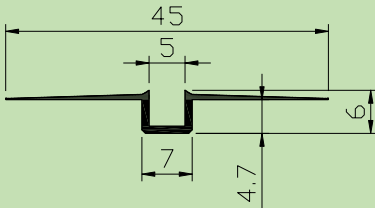
JOINER	H type		J type		HAT type
	H125V	H95V	J125V	J95V	HAT V5
					
Material	PVC		PVC		PVC
Color	White		White		White
Length	2m	1.82m	2.42m	1.82m	2m
Attachable board thickness	12.5mm	9.5mm	12.5mm	9.5mm	12.5mm 9.5mm
MOQ	50pcs	300pcs	50pcs	300pcs	200pcs

# ● Purpose of JOINER (H type, J type)

To connect the joints of the wall board  
To hide the edges of the wall board

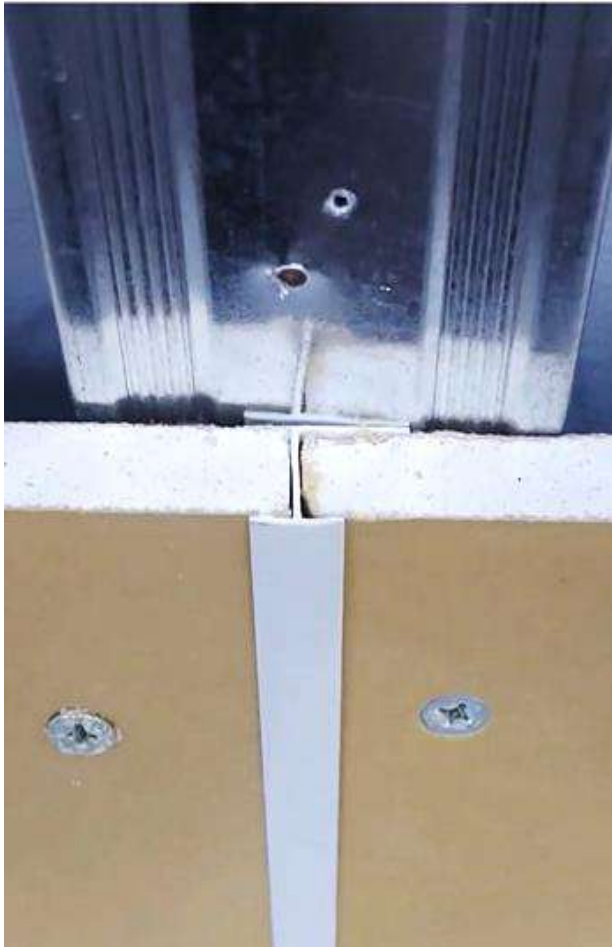
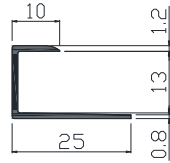
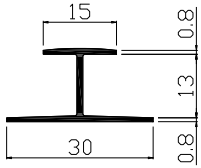

Mainly, these are used for the walls of factories and warehouses

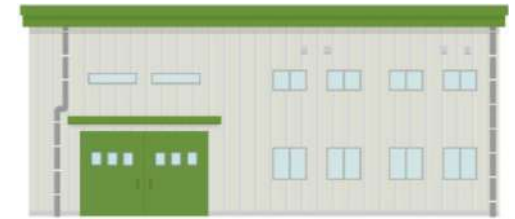

# ● Purpose of JOINER (HAT type)

To prevent cracks

## <Wall without JOINER>

Random cracks

Looks **BAD**

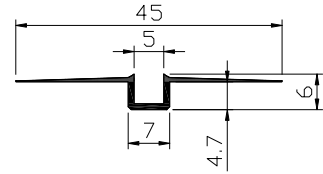
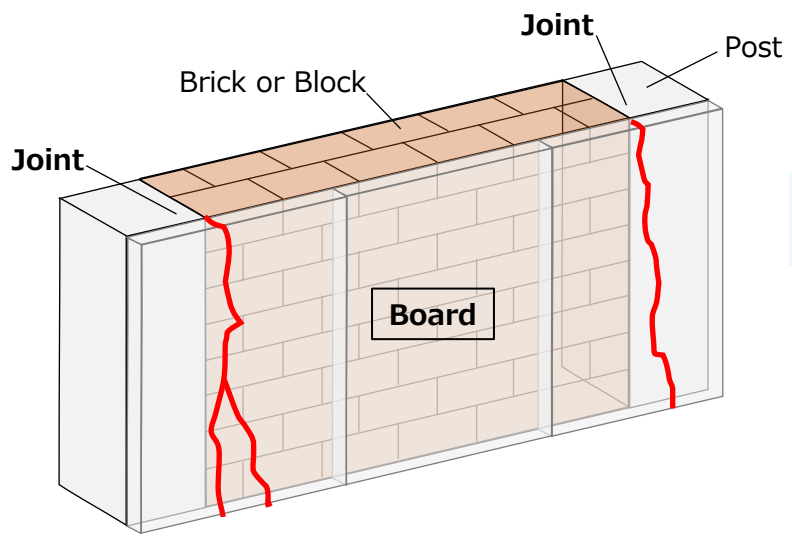

## <Wall with JOINER>

Prevent cracks

Looks **GOOD**

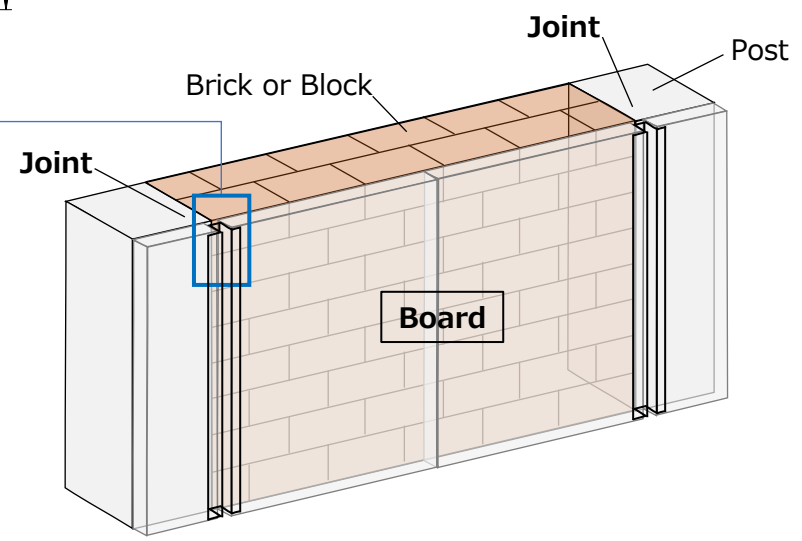
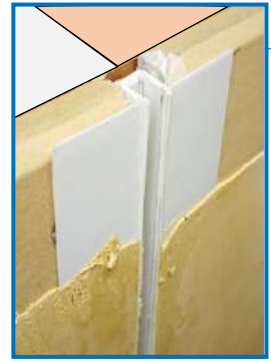

These are used for the walls of houses and stores that require a beautiful finish

Two illustrations: on the left, a modern multi-story apartment building with blue and white panels; on the right, a small storefront with a sign that says 'Café' and a striped awning.

# ● Installation

## H type

## J type

① Fit J type on the edge of board in advance. Then attach the board loosely with screws (Don't fully secure yet). Insert H type into the board

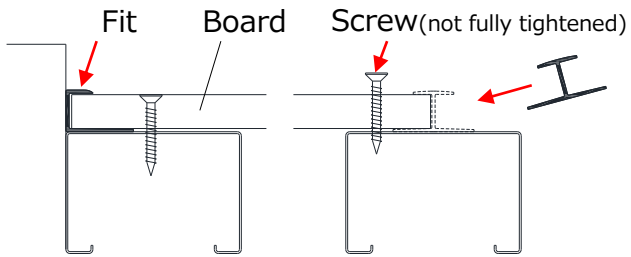

② Tighten the screws and insert the second board

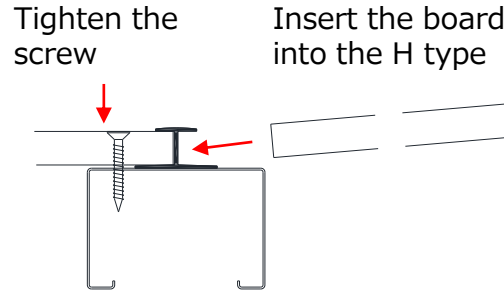

③ Fit J type on the edge of board in advance. Then secure the second board with screws

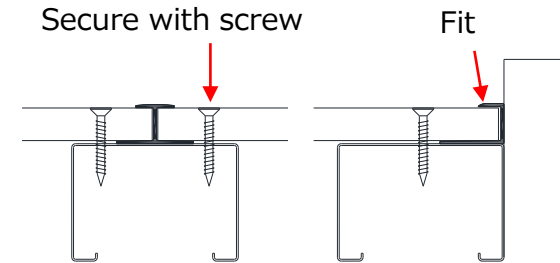

## HAT type

① Install the board

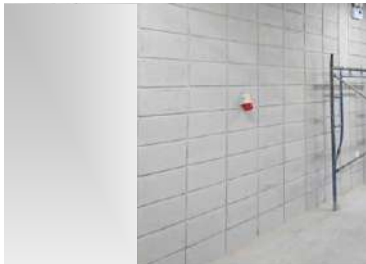

② Secure the HAT type with screws (500 mm pitch) and attach the reinforcing tape

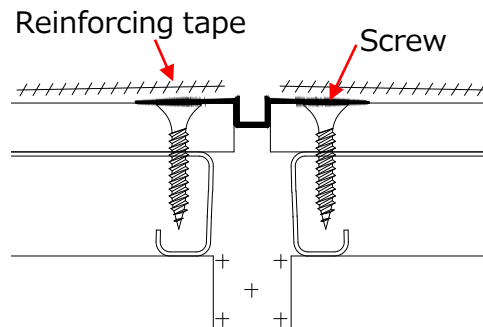
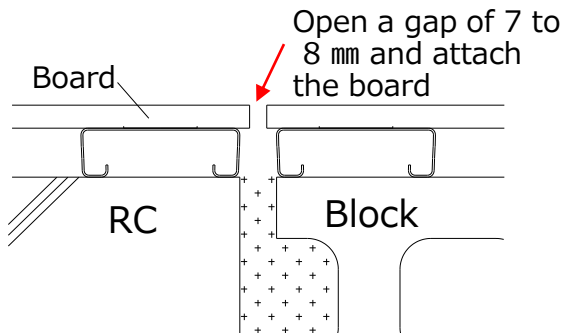

③ Putty and paint

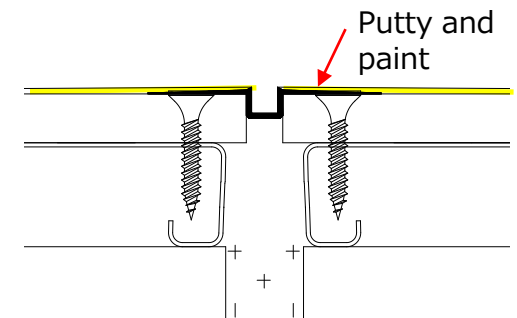

# ● Construction example <JOINER (H type) >

## ■ FACTORY (DONG NAI/VIETNAM)



Connect the joint easily

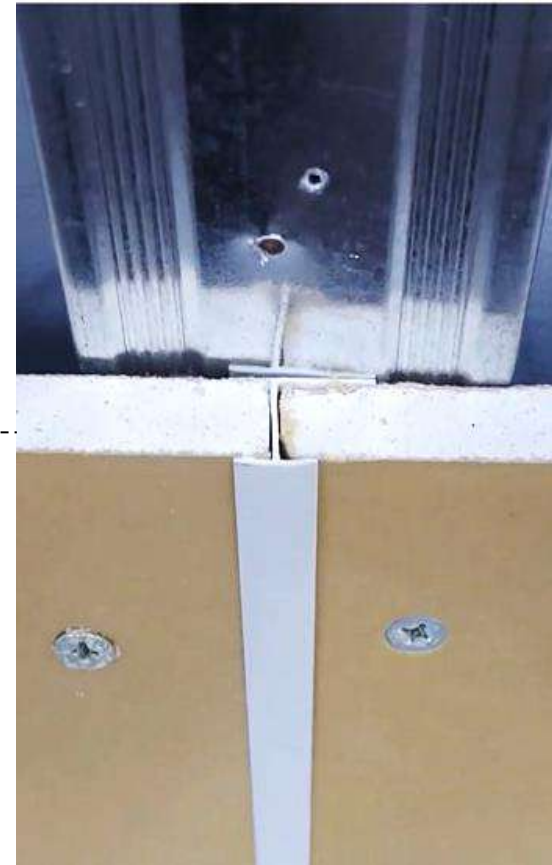

## ■ FACTORY (LONG AN/VIETNAM)

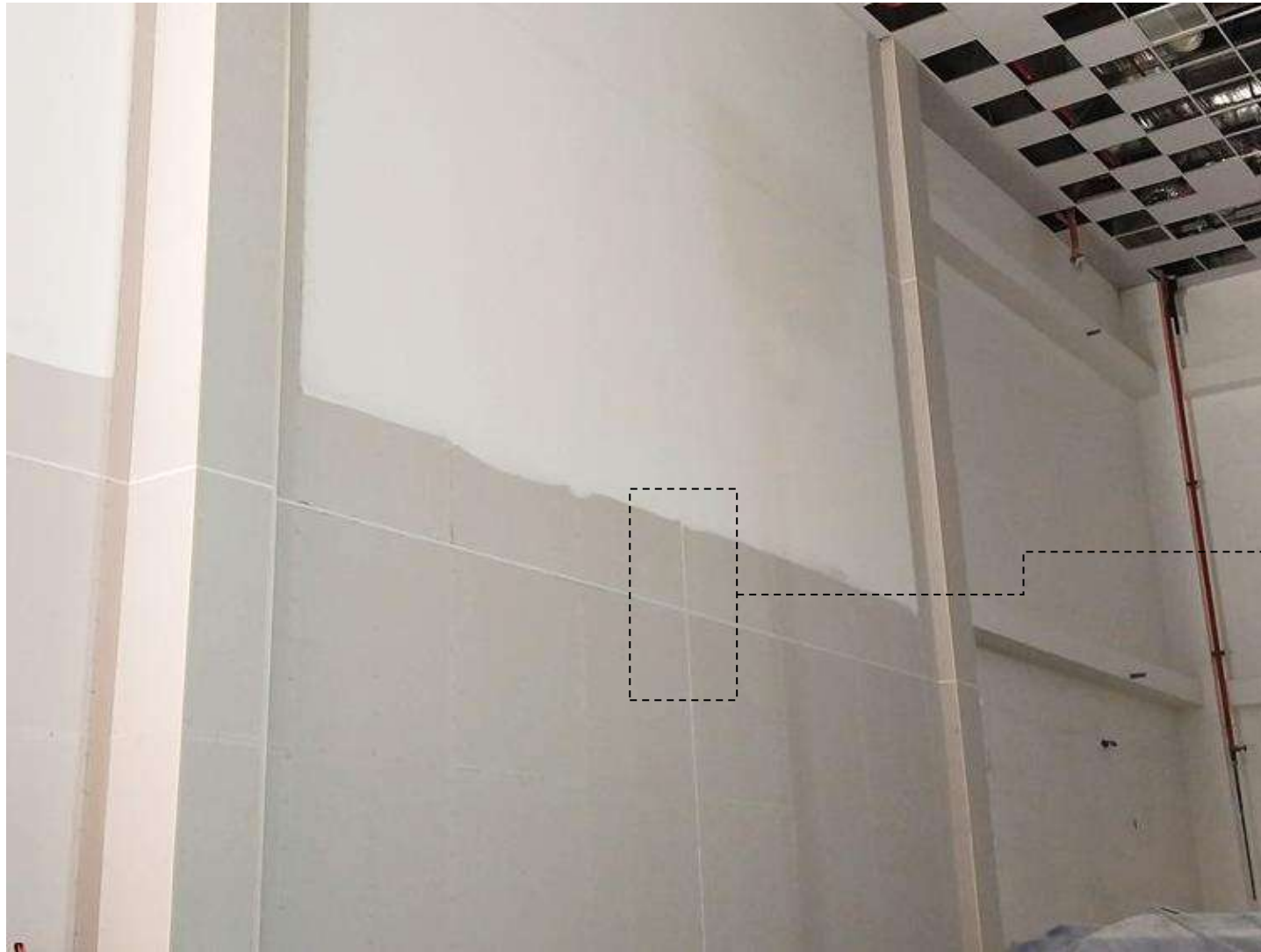

- Connect the joints easily
- Control expansion and shrinking conditions

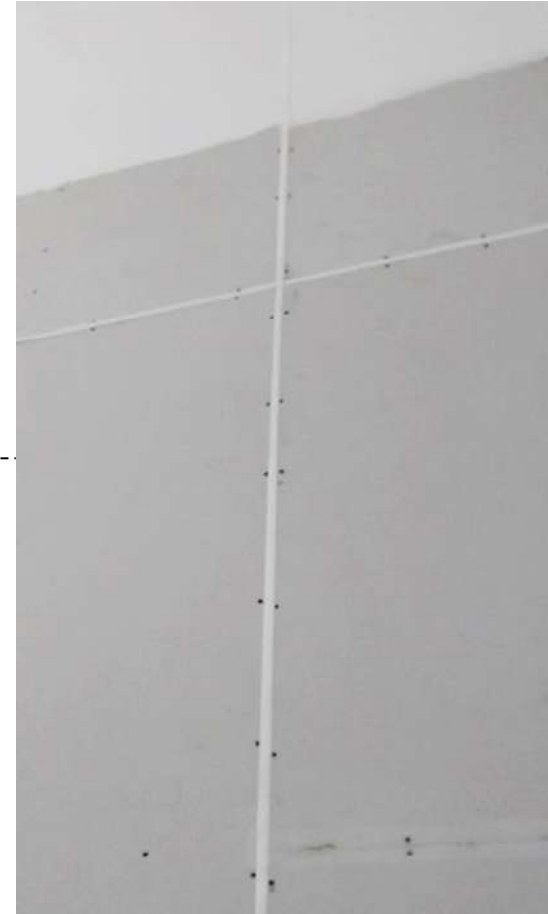

■ FACTORY (DONG NAI/VIETNAM)



<Wall with JOINER>  
Prevent cracks



<Wall without JOINER>  
Random cracks





# ● Construction example <JOINER (J type) >

■ FACTORY (DONG NAI/VIETNAM)

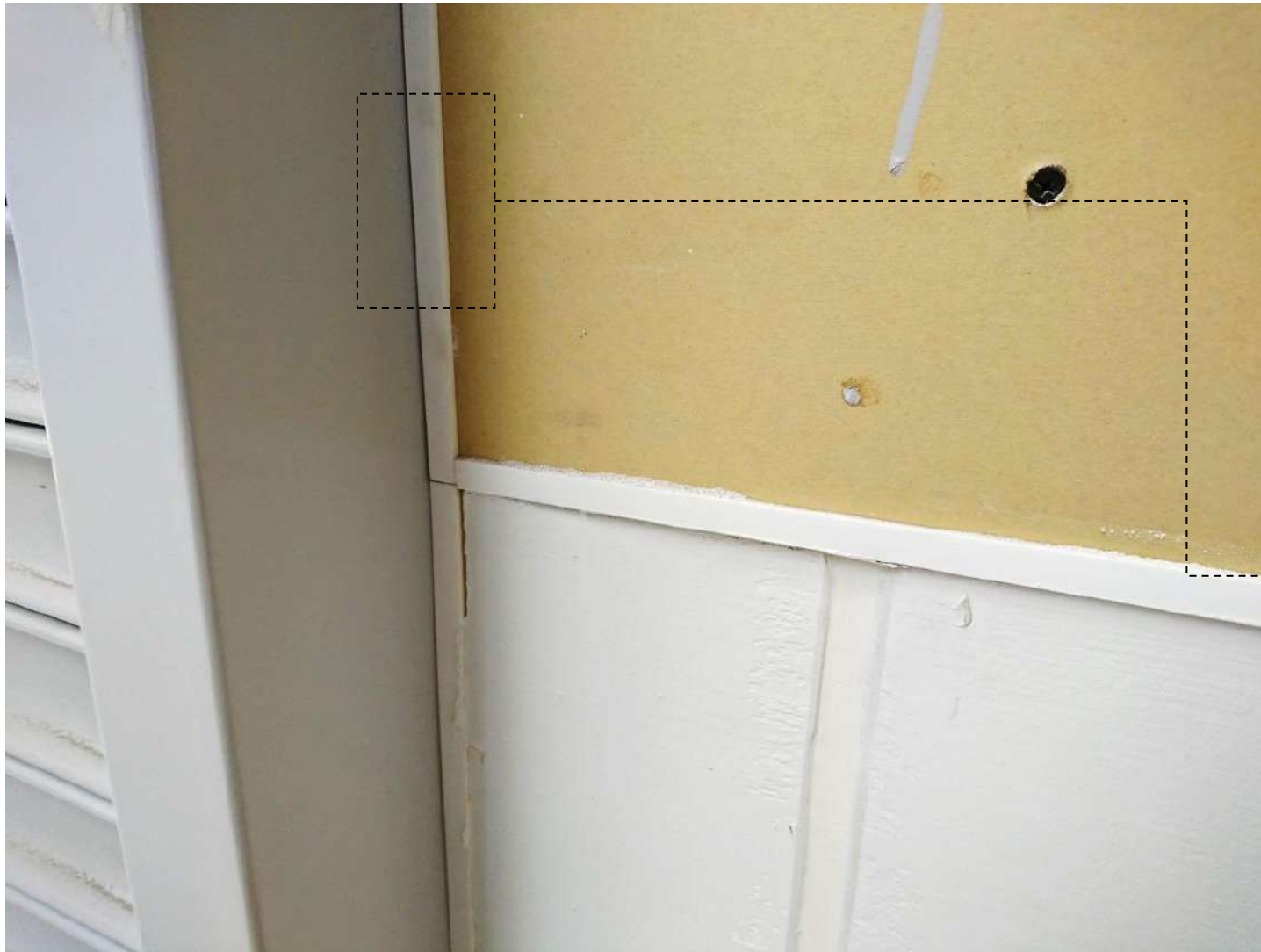

Hide the edges easily



■ **FACTORY (LONG AN/VIETNAM)**

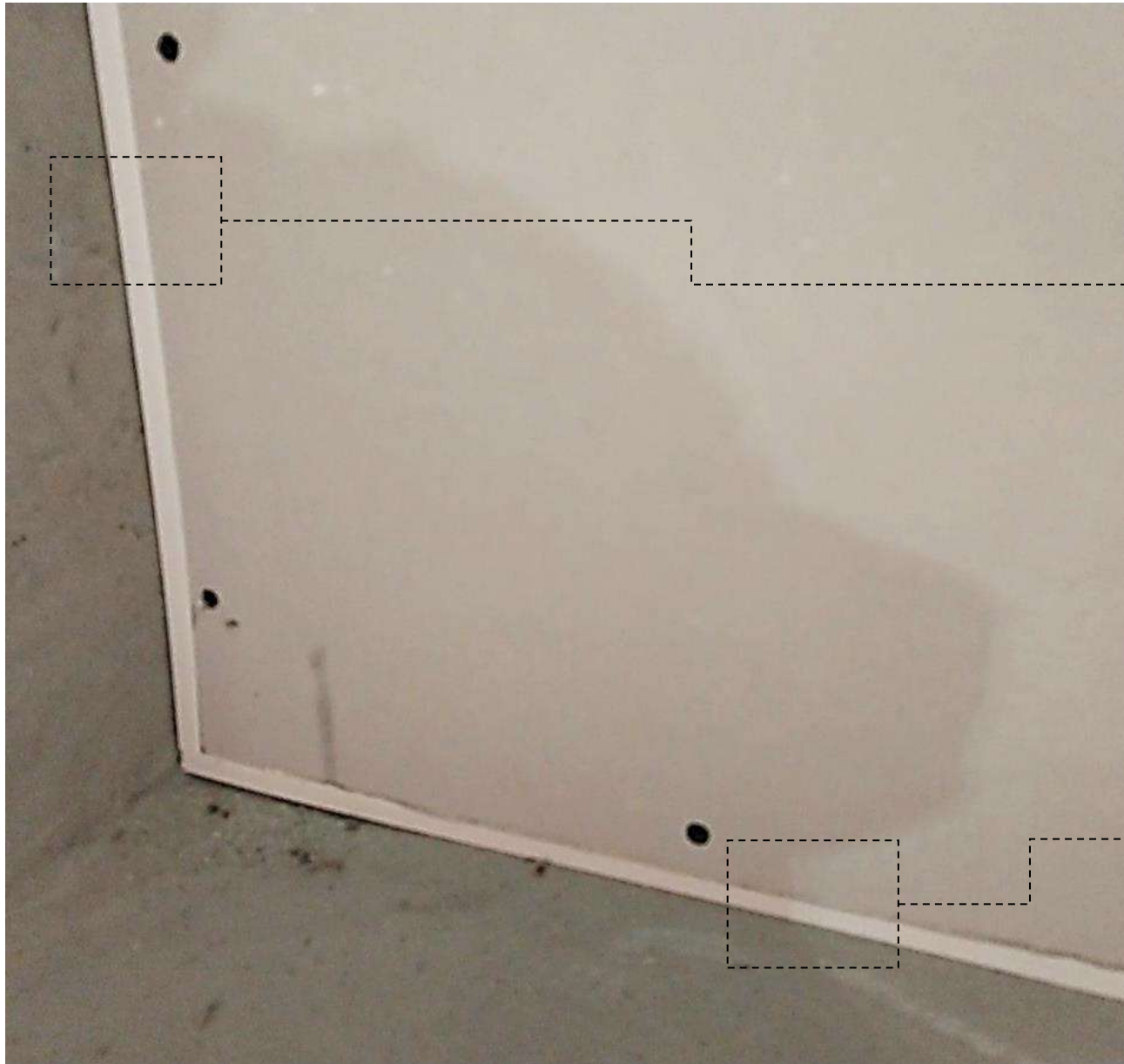

Match a post



Match a floor slab



■ FACTORY (LONG AN / VIETNAM)



Match a door frame



# ● Construction example <JOINER (HAT type) >

■ FACTORY (BA RIA-VUNG TAU /VIETNAM)

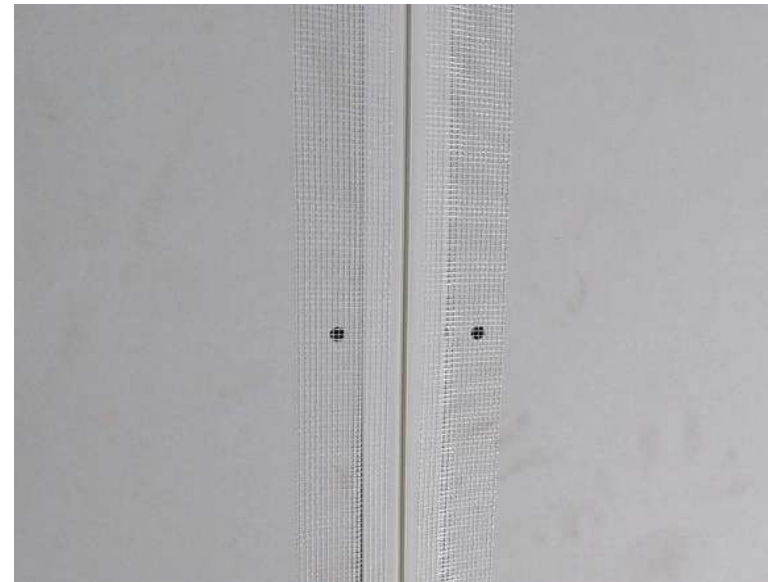

■ OFFICE (HO CHI MINH / VIETNAM) ※Example of using it as a design, not as a crack prevention



■ OFFICE (HO CHI MINH / VIETNAM)

